

Resistance thermometers WTh 26/27/28

4



WTh 26

Technical specifications**Version**

Weld-in resistance thermometer for high pressure and flow loads

Sensor

1 x Pt 100
2-, 3- or 4-wire
Class B, IEC 751

Measuring insert

Replaceable, Ø 6 mm

Thermowell

As per DIN 43772-4
Stainless steel 316 Ti

Neck

Ø 11 x 2 mm, 140 mm long
Stainless steel 316 Ti

Installation lengths (L1/L3)

65/110, 65/140, 65/200,
125/ 200, 125/260

Connection head

(degree of protection)
Type B as per DIN 43729
Aluminium die cast (IP 54)

Measuring range

-35/+550 °C

Options

- Sensor class A
- Without thermowell (thread M 18 x 1.5 or M 14 x 1.5)
- Transmitter installation
- Other thermowell materials, process connections, installation lengths, connection heads

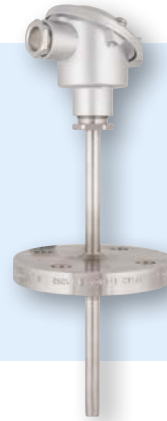

WTh 27

Version

Flanged resistance thermometer for medium pressure and flow loads

Sensor

1 x Pt 100
2-, 3- or 4-wire
Class B, IEC 751

Measuring insert

Replaceable, Ø 6 mm

Flanged thermowell

Several parts, Ø 11 x 2 mm
Flange connection as per EN 1092-1 type B 1, DN 25, PN 40
Stainless steel 316 Ti

Neck

Ø 11 x 2 mm, 120 mm long
Stainless steel 316 Ti

Installation lengths

100, 160, 250, 400 mm

Connection head

(degree of protection)
Type B as per DIN 43729
Aluminium die cast (IP 54)

Measuring range

-35/+400 °C

- Sensor class A
- Reduced measuring tip (6 mm)
- Transmitter installation
- Other thermowell materials, process connections, installation lengths, connection heads



WTh 28

Version

Resistance thermometer for hygienic processes, e.g. food, beverages, pharmaceutical, biotechnology applications

Sensor

1 x Pt 100
2-, 3- or 4-wire
Class B, IEC 751

Measuring insert

Replaceable, Ø 6 mm

Thermowell

Ø 9 x 1 mm, stainless steel 316 Ti

Neck

Ø 9 x 1 mm, 140 mm long
Stainless steel 316 Ti

Process connection

Either clamp, screw connection
DIN 11851, weld-in ball, weld-in socket

Installation length

100, 125, 160, 250, 400 mm

Connection head

(degree of protection)
Type B, type BUZ
Aluminium die cast (IP 54)

Measuring range

-35/+300 °C

- Sensor class A
- Reduced measuring tip (6 mm)
- Other thermowell materials
- Other process connections
- Other installation lengths
- Transmitter installation
- Field housing

i

See page 292 for wiring diagram.

See the catalogue DOMESTIC TECHNOLOGY for versions as injection-type and outdoor resistance thermometers for use in air ducts.

Resistance thermometers WTh 26/27/28

Dimensions (mm)

Type WTh 26

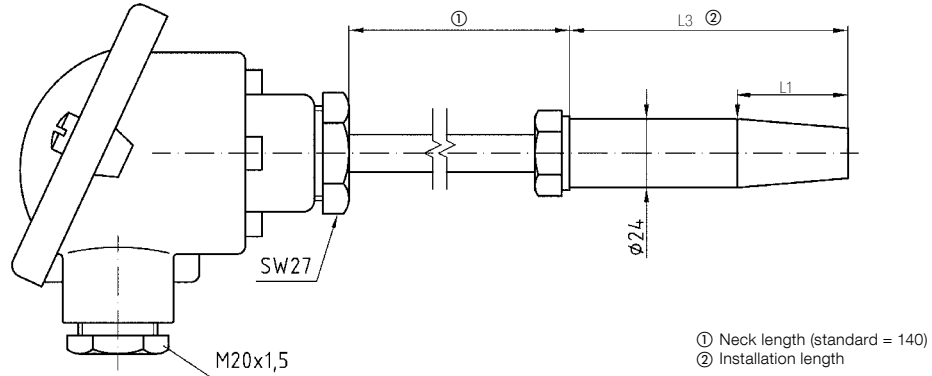

Type WTh 27

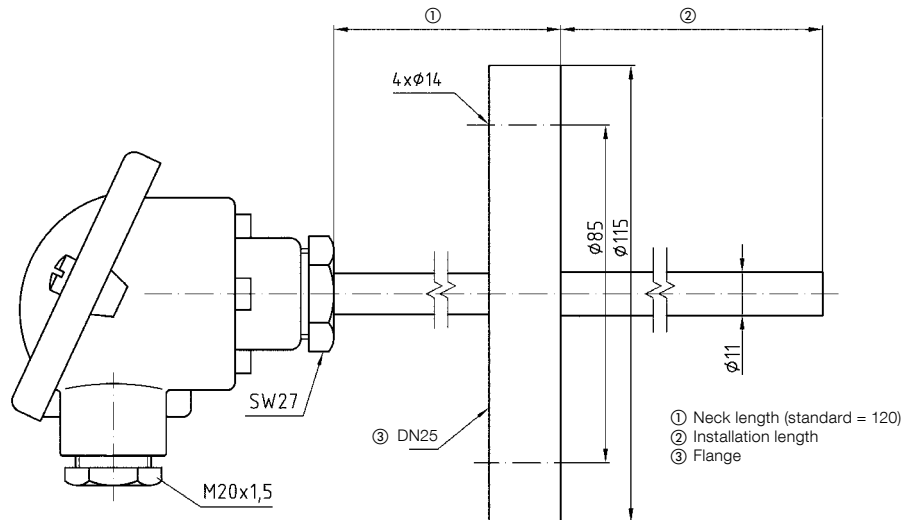

Type WTh 28

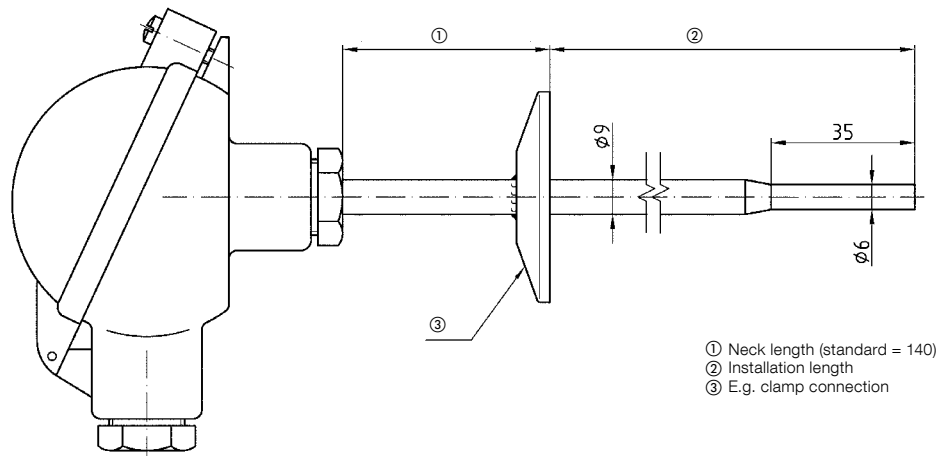

Resistance thermometers

DG: H, PG: 4

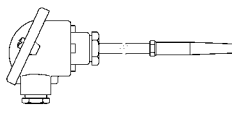
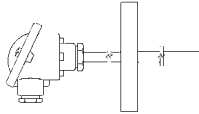
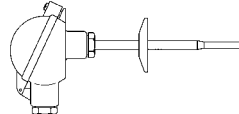
Type	WTh 26	WTh 27	WTh 28
Version			
Sensor	1 x Pt 100 3-wire, class B	1 x Pt 100 3-wire, class B	1 x Pt 100 3-wire, class B
Thermowell/probe Diameter Material	Weld-in thermowell as per DIN 43772 Stainless steel 316 Ti	11 mm Stainless steel 316 Ti	9 mm Stainless steel 316 Ti
Neck	140 mm	120 mm	140 mm
Process connection	Weld-in thermowell as per DIN 43772*	Flange EN 1091-1 Type B1 DN 25/PN 40	Clamp 1"
Connection head/ Electr. connection	DIN 43729, type B Cable gland	DIN 43729, type B Cable gland	Type B, type BUZ Cable gland
Measuring range	-35/+550 °C	-35/+400 °C	-35/+200 °C
Installation length	Price € Part no.	Price € Part no.	Price € Part no.
65 mm	32250	---	---
100 mm	32251	32260	32230
125 mm	---	---	32231
160 mm	32253	32261	32232
250 mm	32254	32262	32233
400 mm	---	32263	32234
Extra charges (without PG)	Price €	Price €	Price €
Per additional 100 mm installation length ***	---		
Transmitter installation* DC 7.5–30 V/4–20 mA			
1 x Pt 100 4-wire			
2 x Pt 100 2-wire			
Sensor class A			
Reduced measuring tip (Ø 6 mm) for 1 x Pt 100	---		
Clamp 1½"	---	---	On request
DIN 11851, DN 40	---	---	On request
Hygienic, DN 40	---	---	On request
Weld-in ball	---	---	On request
Weld-in socket	---	---	On request

* Enquire for thermowells made of other materials.

** Applies to standard measuring ranges (-50/+50, 0/50, 0/100, 0/120, 0/150, 0/200, 0/300, 0/400, 0/500 °C), extra charge in all other cases €

*** Applies up to 1,000 mm, one-time extra charge for installation length greater than 1,000 mm €

Blue part no. = in-stock items